



HALLOWEEN PUMPKIN CARVING SET

GRÆSKAR-SNITTESÆT

Operating and safety information

GRÆSKAR-SNITTESÆT
Betjenings- og sikkerhedsanvisninger

KÜRBIS-SCHNITZSET
Bedienungs- und Sicherheitshinweise

IAN 458971_2401

citygate24 GmbH
Ailstädter Straße 8
20095 Hamburg
GERMANY

06/2024
Model No.: 1183-11

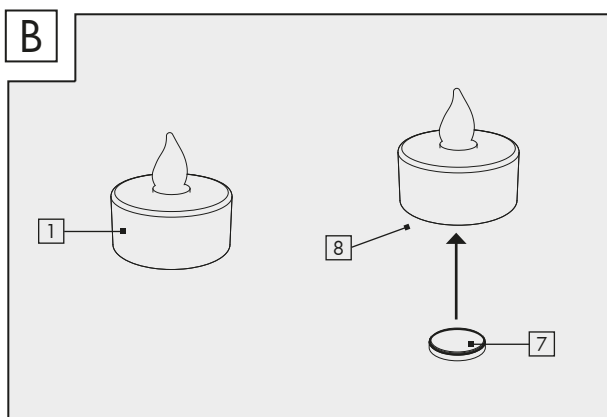
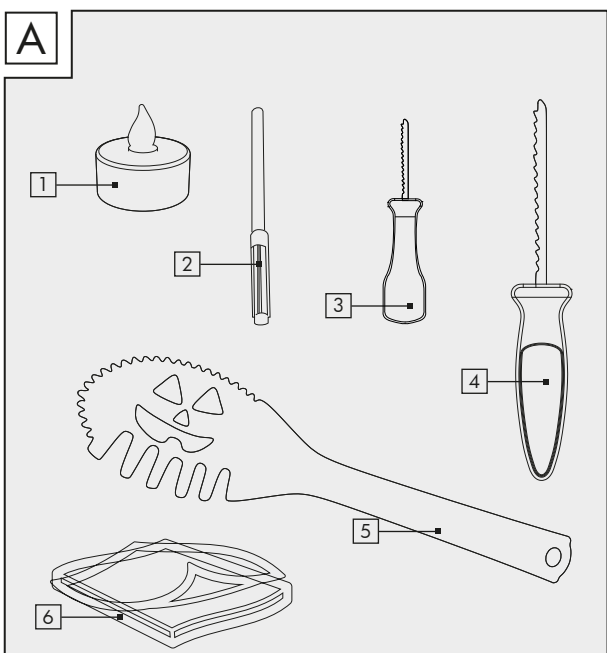

GB IE NI

Halloween Pumpkin Carving Kit

Introduction

i Congratulations on the purchase of your new product. You have chosen a high-quality product. Please read these operating instructions thoroughly and carefully. These instructions are an essential part of the product and contain important information on first-time use and handling. Always observe all safety instructions. If you have any questions or are unsure how to operate the product, please contact your retailer or service centre. Please keep this manual in a safe place and pass it on to third parties where necessary.

Explanation of symbols

- i** Read the operating instructions!
- Issue date of user instructions (month/year)
- Date of manufacture (month/year)
- Direct current
- Risk of fatal injury and accidents for infants and children!
- Observe warning notices and safety instructions!
- Explosion hazard!
- Wear protective gloves!
- This symbol indicates that the product operates with safety extra-low voltage (SELV / PELV, protection class III).
- Suitable for indoor use only
- 1x CR2032 battery included in delivery
- Battery included
- WARNING: Contains coin/button battery. Hazardous if swallowed – see instructions.
- Keep out of reach of children
- Do not use violence!
- Never use different systems, brands and types at the same time!
- Do not insert the wrong way round, observe polarity (+ / -)!
- Do not throw into the fire!
- Do not throw it into the water!
- Do not short-circuit! Batteries can explode or leak.
- Never mix new and used batteries!
- Do not recharge!
- Do not disassemble / open!
- Dispose of packaging and product in an environmentally friendly manner!
- Risk of environmental damage from incorrect disposal of (rechargeable) batteries!
- Packaging made of FSC-certified wood mix
- With the CE label, the manufacturer confirms that this product complies with the applicable European directives.
- Products marked with this symbol meet all applicable regulations and requirements in the economic area of the United Kingdom of Great Britain.
- Address of supplier

Intended use

Not suitable for children under 12 years. This product is only suitable for decorative purposes. This product is intended exclusively for indoor use in dry and enclosed spaces. The LED decorative tea light must not be placed inside the pumpkin when it is not in an enclosed space. The product is not suitable for general indoor lighting in the home or for commercial use. This product is intended for use in private households only. Any type of use other than that described above or any modification of the product is prohibited and likely to cause damage or even personal injury. The manufacturer or retailer accepts no liability for loss or damage that occurs as a result of improper or incorrect use.

Included in package

- 1x LED decorative tea light
- 1x pumpkin scraper
- 1x large saw
- 1x small saw
- 1x pen
- 1x battery (CR2032)
- 6x carving templates
- 1x user instructions

Description of parts

- | | |
|--------------------------|-------------------|
| LED decorative tea light | Pumpkin scraper |
| Pen | Carving templates |
| Small saw | Battery |
| Large saw | On/Off switch |

Technical specifications

Model number: 1183-11
Input: 1 x CR 2032, 3 V 0,08 W
Protection class: III
Light colour: warm white

Battery manufacturer:
Name: SUZHOU XINIVZHOU ELECTRONICS CO., LTD.
Address: SHANJI ROAD 158, XIANGCHENG DISTRICT, SUZHOU CITY, JIANGSU, CHINA.
Trade name: WARRIORS CR2032 3V LITHIUM CELL
www.lvzhoudianzi.com.cn
E-mail: 593221152@qq.com
Contact: Qiankeyun

Safety instructions

Safety instructions

WARNING!
RISK OF FATAL INJURY AND ACCIDENTS TO INFANTS AND CHILDREN! Never leave children unsupervised with the packaging material. There is a danger of suffocation from the packaging material. Children often underestimate the dangers. Always keep children away from the product..

- Caution!** Only for use under adult supervision.

- Caution!** Keep tools out of reach of children after use.

- Cleaning and battery replacement may not be carried out by children.
- Keep the product away from children until you have removed the protective strip from the battery compartment.
- Do not use the product if you notice any defects.
- Protect the product from sharp edges, mechanical stress and hot surfaces.
- Do not immerse the product in water or any other liquids.
- The LEDs can be replaced by specialised personnel.

Safety Instructions for (Rechargeable) Batteries

- RISK OF FATAL INJURY!** Keep (rechargeable) batteries out of the reach of children. If swallowed, seek medical advice immediately!
- EXPLOSION HAZARD!** Never recharge non-rechargeable batteries. Do not short-circuit or open (rechargeable) batteries. They could overheat, cause a fire or explode.
- Never throw (rechargeable) batteries into fire or water.
- Do not expose (rechargeable) batteries to mechanical stress.
- Do not use different battery types or use new and used batteries together.
- Insert the supplied batteries into the product, taking care to ensure correct polarity.
- Do not short-circuit the terminals!
- Remove empty batteries from the product.
- Caution!** This product contains a coin battery (button cell containing lithium). Coin batteries can cause severe internal chemical burn injuries when swallowed.
- Caution!** Dispose of spent batteries immediately. Keep the batteries out of reach of children! If a battery is swallowed, seek medical advice immediately.

Risk of (rechargeable) batteries leaking

- Avoid exposing (rechargeable) batteries to extreme conditions and temperatures, e.g. radiators or direct sunlight.
- Avoid contact with skin, eyes and mucous membranes! In the event of skin contact with battery acid, rinse the affected area immediately with plenty of clean water and seek medical advice immediately!
- WEAR PROTECTIVE GLOVES!** Leaking or damaged (rechargeable) batteries can cause chemical burns if they come into contact with skin. Therefore, wear suitable protective gloves in such cases.
- In the event that a battery leaks, remove it from the product immediately to avoid damage.

Setup

- Instructions:** Take the product out of its packaging and remove all packing material.
- Check that all package contents are present.
 - Check if the product or individual parts are damaged. If that is the case, do not use the product. Please contact the retailer via the service address indicated on the warranty card.
 - Keep the product away from children until you have removed the protective strip from the battery compartment.
 - The batteries supplied are already inserted into the product and fitted with an isolator strip. Remove this plastic strip to start using the product.

Inserting/replacing the batteries

- RISK OF FATAL INJURY!** Please note that the batteries must only be replaced by adults. Ensure that the battery compartment is firmly closed. Batteries can be lethal when swallowed!
- The battery compartment is located on the bottom of the LED decorative tea light (see Fig. B).
- Undo the screws to open the battery compartment and remove the discharged battery.
- Now insert a new battery (CR2032).
- Please note:** It is essential to pay attention to the correct polarity.
- Close the battery compartment lid and refasten the screws to seal it.

Operation

CAUTION! Never leave children unsupervised when using the product! Only for use under adult supervision.
LED decorative tea light: The ON/OFF switch is located on the bottom of the LED decorative tea light (see Fig. B). Push the switch to the ON position to switch the product on. The flame will now illuminate with a natural flickering effect. Push the switch to the OFF position to switch the product off.

CAUTION! Once the LED light or the LED decorative tea light has been placed inside the pumpkin, the pumpkin is no longer suitable for consumption. Pumpkin scraper: The pumpkin scraper (see Fig. A) is designed for removing the flesh and seeds from inside the pumpkin.

Small saw / Large saw: You can use the saws / (see Fig. A) for precise carving.
Pen: You can use the pen (see Fig. A) to transfer the carving template patterns onto the pumpkin.

CAUTION! Once you have drawn on the pumpkin with the pen, the pumpkin is no longer suitable for consumption. Carving templates: The carving templates make it easier to design the pumpkin.

Cleaning and storage

- Do not immerse the LED decorative tea light in water. Make sure that no water gets into the casing.
- Use only a dry, lint-free cloth for cleaning. If the product is very dirty, dampen the cloth slightly.
- When the product is not in use, store inside the packaging in a dry place.
- You can clean the carving tools / / under running water. Do not use any aggressive cleaning agents.

Troubleshooting

- = Fault
- = Cause
- = Solution
- = The LED decorative tea light is not switching on.
- = The product is switched off.
- = Turn the product on (see section "Operation")
- = The batteries are discharged.
- = Replace the batteries (see "Replacing the batteries").

Disposal

Note the labels on the packaging materials when sorting the waste; they are marked with abbreviations (a) and numbers (b) with the following meanings:
1-7: Plastics
20-22: Paper and cardboard
80-98: Composite materials
 You can find out how to dispose of the used product by contacting your local district or city council.
 In the interest of environmental protection, when the product has reached the end of its useful life, do not dispose of it as general household waste but have it properly recycled. For information on recycling centres and their opening times, please contact your local council.

Faulty or used batteries must be recycled in accordance with Directive 2006/66/EC and its amendments. Return batteries and/or the product to the local recycling facilities provided.

Risk of environmental damage from incorrect disposal of rechargeable batteries!
Batteries must not be disposed of as general household waste. They may contain toxic heavy metals* and are subject to special waste treatment. Batteries and rechargeable batteries that are not permanently fixed inside the product must be removed before disposal of the product and disposed of separately. Please ensure batteries/rechargeable batteries are fully discharged when disposed of! Wherever possible, use rechargeable batteries rather than single-use batteries.
*) Marked as followed: Cd = cadmium, Hg = mercury, Pb = lead

Warranty

Dear customer, This product comes with a 3-year warranty from the date of purchase. In the event that this product is faulty, you have legal rights against the seller of the product. These statutory rights are not restricted by our warranty as set out below.

Warranty terms

The warranty period begins with the date of purchase. Please keep the original receipt in a safe place. It is required as proof of purchase. If a material or manufacturing defect occurs within three years of the date of purchase, we will repair or replace the product for you free of charge, or refund the purchase price, at our discretion. This warranty service is granted provided that the faulty device and the proof of purchase (receipt) are presented within three years, along with a brief written description of the fault and of when it occurred. If the fault is covered by our warranty, we will return the fixed product or send you a new one. No new warranty period shall begin upon repair or replacement of the product.

Warranty period and statutory warranty claims

The warranty period is not renewed after a warranty service has been granted. This rule shall also apply for any replaced or repaired parts. Any damage or faults that already existed when buying the product must be reported immediately upon unpacking the product. A fee is charged for any repairs that are carried out after the end of the warranty period.

Warranty scope

The device was carefully manufactured according to the strictest quality guidelines and thoroughly tested before delivery. The warranty covers material and manufacturing defects as well as the battery. This warranty does not apply to product parts that are subject to normal wear and tear and can thus be regarded as wearing parts; nor does it cover damage to fragile parts, such as switches or parts made of glass. This warranty is void if the product has been damaged, improperly used or serviced. To ensure proper use, all instructions included in the manual must be followed carefully. All uses and actions that users are discouraged from or warned of in the manual must be avoided under all circumstances. The product is intended for private household use only, and not for commercial activities. The warranty is void, if the product is treated inappropriately, if force is applied, and in the case of any manipulation that is not carried out by our authorised service branch.

Warranty processing

To ensure your request is handled swiftly, please observe the following **Notes:**

- Please have the receipt and the article number (e.g. IAN 123456) ready as proof of purchase for all enquiries.
- Please refer to the type plate on the product, an engraving on the product, the cover of the manual (bottom left) or the sticker on the back or base of the product to find out the product number.
- In the case of any malfunctions or other defects, please call or email the service department indicated below as a first step.
- After your product has been registered as faulty, you can send it to the specified service address, free of charge. Please include the proof of purchase (receipt) and information about the defect and about when it occurred.

Service

GB
Service Great Britain
Tel. : 00800 80040044
E-Mail: administration@mynetsend.de

IE NI
Service Ireland
Tel. : 00800 80040044
E-Mail: administration@mynetsend.de

IAN 458971_2401

Please have the receipt and the article number (e.g. IAN 123456) ready as proof of purchase for all enquiries.

You can find an up-to-date version of the operating instructions at: www.citygate24.de

You can download this and many other manuals, product videos and installation software at **www.lidl-service.com**. Scanning the QR code on the front page will take you directly to the Lidl Service web page (www.lidlservice.com) where you can access the user instructions by entering the item number (IAN) 123456_7890.

DK

Græskar-snittesæt

Indledning

i Vi ønsker dig tillykke med købet af dit nye produkt. Du har dermed valgt et førsteklases produkt. Du bedes læse denne instruktionsbog helt og grundigt igennem. Denne instruktionsbog hører til dette produkt og indeholder vigtige henvisninger til opstart og håndtering. Vær altid opmærksom på alle sikkerhedsanvisninger. Hvis du har spørgsmål eller er usikker i forhold til håndtering af produktet, bedes du kontakte din forhandler eller vores kundeservice. Du bedes opbevare denne instruktionsbog og eventuelt videregive den til tredjemand.

Tegnforklaring

- i** Læs instruktionsbogen!
- Instruktionsbogen er udgivet (måned/år)
- Produktionsdato (måned/år)
- Jævnspænding
- Overhold advarsler og sikkerhedsanvisninger!
- Livsfare og fare for ulykker for småbørn og børn!
- Eksplosionsfare!
- Bær beskyttelseshandsker!
- Dette symbol betyder, at produktet arbejder med lavspænding (SELV / PELV) (beskyttelsesklasse III).
- Kun til indendørs brug
- Inklusive 1x CR2032 batterier
- Inklusive batterier
- ADVARSEL: Indeholder en knapcelle. Den er sundhedsskadelig ved slugning - se anvisninger
- Skal opbevares utilgængeligt for børn
- Anvend ikke vold!
- Anvend aldrig forskellige systemer, mærker og typer samtidigt!
- Må ikke indsættes omvendt, polaritet (+ / -) skal overholdes!
- Må ikke smides ind i åben ild!
- Må ikke smides ned i vand!
- Må ikke kortsluttes! Batterier kan eksplodere eller lække.
- Nye og brugte batterier må aldrig blandes!
- Må ikke genoplades!
- Må ikke skilles ad / åbnes!
- Emballage og produkt bortskaffes miljøvenligt!
- Miljøskader ved forkert bortskaffelse af batterierne/akkumulatorene!
- Emballage af FSC-certificeret blandingstræ
- Med CE-mærkningen bekræfter producenten, at dette produkt overholder de gældende europæiske direktiver.
- Products marked with this symbol meet all applicable regulations and requirements in the economic area of the United Kingdom of Great Britain.
- Address of supplier

Forskriftsmæssig anvendelse

Kun egnet til børn fra 12 år.
Dette produkt er kun egnet til dekoration. Dette produkt er udelukkende egnet til anvendelse indendørs, i tørre og lukkede rum. LED-deko-fyrtdslyset må ikke placeres i græskarret, hvis det befinder sig uden for lukkede rum. Produktet er ikke egnet til rumbelysning i hjemmet samt til kommerciel anvendelse. Dette produkt er kun beregnet til anvendelse i private hjem. En anden anvendelse end tidligere beskrevet eller en ændring af produktet er ikke tilladt og kan føre til materielle skader eller endda personvæstelser. Producenten eller forhandleren tager ikke ansvar for skader, som måtte være opstået på grund af ikke forskriftsmæssig eller forkert anvendelse.

Leveringsomfang

- 1x LED-deko-fyrtdslys
- 1x græskarskraber
- 1x stor sav
- 1x lille sav
- 1x stift
- 1x batteri (CR2032)
- 6x snitteskabeloner
- 1 x instruktionsbog

Delbeskrivelse

- | | |
|--------------------|------------------|
| LED-deko-fyrtdslys | Græskarskraber |
| Stift | Snitteskabeloner |
| Lille sav | Batteri |
| Stor sav | ON-/OFF-taste |

Tekniske data

Modelnummer: 1183-11
Indgang: 1 x CR 2032, 3 V 0,08 W
Beskyttelsesklasse: III
Lystarve: varm hvid

Producent af batterier:
Navn: SUZHOU XINIVZHOU ELECTRONICS CO., LTD.
Adresse: SHANJI ROAD 158, XIANGCHENG DISTRICT, SUZHOU CITY, JIANGSU, CHINA.
Trade name: WARRIORS CR2032 3V LITHIUM CELL
www.lvzhoudianzi.com.cn
E-mail: 593221152@qq.com
Contact: Qiankeyun

